

VILLAGE PROPERTY



1005/2A Elsie Street Burwood NSW

2 2 1

Available from 17th January 2024

Designed by famous architects Turner, have created an alluring new landmark right in the beating heart of Burwood, on the doorstep of Burwood Park. Capturing glorious predominantly northerly views from the city skyline to the majestic Blue Mountains, this slender, elegant building is a spectacle of glass and light. Encompassing a maximum just five residences per floor, it has a boutique feel.

- Modern kitchen with Smeg appliances including gas stove, dishwasher, oven and rangehood
- Expansive balcony that draw in city/park views and light deep into apartments

Type : Apartment

Price : \$920 Per Week

View : <https://www.villageproperty.com.au/lease/nsw/inner-west/burwood/residential/apartment/7842089>



Aimee-Jo Azzi
1300 62 44 00

[For full version visit the website](https://www.villageproperty.com.au)

<https://www.villageproperty.com.au>

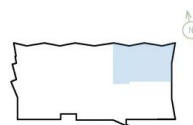

ATLAS
PROPERTY HOLDINGS PTY LTD

CBRE