

# VILLAGE PROPERTY



**320/280 Jones Street Pyrmont NSW**

2  1  1 

Available 15th July

Harbour Mill is perfectly located for those who desire everything at their doorstep. Seamlessly combining iconic heritage character in a historic warehouse with a stunning ultra contemporary architectural design.

The site adjoins the Wentworth Park Light Rail Station, which is cleverly linked to central Station and Dulwich Hill via Leichardt, Glebe, Darling Harbour and Haymarket. Residents can enjoy an easy stroll around Darling Harbour into the CBD, getting you to the heart of the city in no time. Walking distance to cafes, shops and bus routes to the city.

Lease periods are 6-12 months. No pets.

[For full version visit the website](https://www.villageproperty.com.au)

**Type** : Apartment

**Price** : \$850 Per Week DEPOSIT TAKEN

**View** : <https://www.villageproperty.com.au/lease/nsw/sydney-city/pyrmont/residential/apartment/8047825>



**Alan Wang**  
1300 62 44 00

<https://www.villageproperty.com.au>



APARTMENT  
**320**  
1 BEDROOM + STUDY

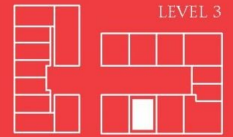

INTERNAL	71M <sup>2</sup>
EXTERNAL	7M <sup>2</sup>
TOTAL	78M <sup>2</sup>
CAR	1



**HARBOUR MILL**  
PYRMONT

Disclaimer: The information, images and illustrations are indicative only and are subject to change. PHM Pty Ltd and related companies and their agents do not warrant the accuracy of the information and images and do not accept any liability for any error or discrepancy. The information and images used may not form part of any Contract for Sale. Interested parties must rely on their own enquiries and the information in the Contract for Sale for the development. All architectural images are computer generated and are artist impressions only.

