

VILLAGE PROPERTY



E409/310-330 Oxford Street Bondi Junction NSW

2 2 1

DEPOSIT TAKEN

Situated in the heart of Bondi Junction, 'The Forum' offers the ultimate convenience to Bondi Junction train station, Bondi Westfield Shopping Centre, minutes to Eastern Suburbs Beaches and Centennial Park. Abundance of restaurants and cafes moments away. Less than 15mins drive to Sydney CBD and a short bus ride to world famous Bondi Beach.

Take advantage of this limited opportunity to live in a highly desirable location.

Lease periods are 6-12 months. Pets to be considered at landlord's discretion.

[For full version visit the website](https://www.villageproperty.com.au/lease/nsw/eastern-suburbs/bondi-junction/residential/apartment/8115590)

Type : Apartment
Price : DEPOSIT TAKEN
View : <https://www.villageproperty.com.au/lease/nsw/eastern-suburbs/bondi-junction/residential/apartment/8115590>



Alan Wang
1300 62 44 00

<https://www.villageproperty.com.au>

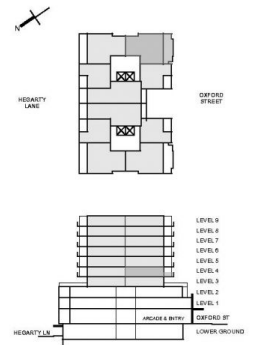

FORUM EAST, E07

INTERNAL	81 m ²
OUTDOOR	20 m ²
TOTAL	101 m ²

